

## W-BEAM METAL CRASH BARRIER or GUARD RAIL

The Guard rail or Metal Beam Crash Barrier are very effective road safety systems which help in protecting vehicles and the passengers in case of an accident and also serve as a good visual guide for drivers , especially in the night. SAI supplies the best guard rails which are strong, sturdy and aesthetic.

- Guard rail are cold formed section and hot dip galvanized to 550 GSM
- Raw material conforming to IS : 5986 Gr. Fe 360 / Fe 410, IS 10748 Grade II or equivalent.
- Fish Tail & End Beams are supplied as per customer requirements.

SECTION	LENGTH (mm)	SIZE (mm)	THICKNESS (mm)
SECTION	4318	310x2	2.67 - 3.5
THREE BEAM	4318	518	2.67 - 3.5
POST	1200 - 2000	150 X 75	5
SPACER	330 - 530	150 X 75	5

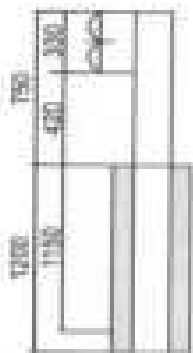
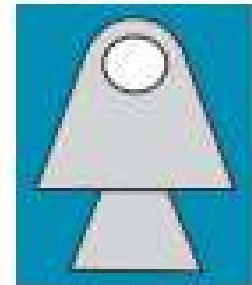

Single Side  
Single Beam

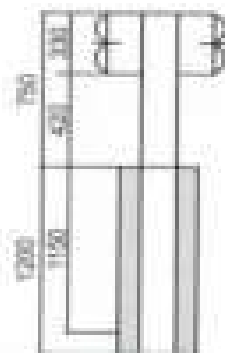

Double Side  
Single Beam

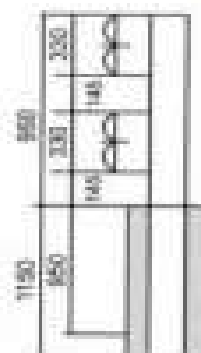

Single Side  
Double Beam

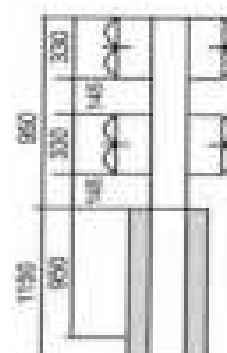

Double Side  
Double Beam

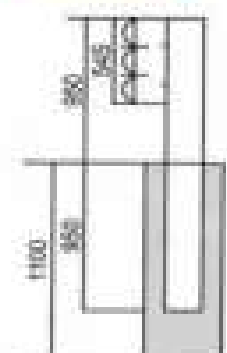

Single Side  
Three Beam



## **REPAIR AND REHABILITATION OF BRIDGES**



**SAI** with an Integrated Design and Project Divisions also undertake Repair and Rehabilitation of Bridges under difficult site condition.

SAI offers specialized repair services for:

- Lifting of Bridge Superstructures
- Realignment and Replacement of distressed Bearings
- Replacement of failed/ defunct Expansion Joints
- Strengthening using Epoxy/ non shrink grouts
- Repair of cracks and concrete spallings
- External Pre-stressing
- Jacketing, Shotcreting and Guniting
- Repair of Wearing course
- Laying of Mastic Wearing Course
- Provision of proper drainage systems
- Honeycombing

SAI has fully equipped workshop having all the latest equipment and facilities for Foot Over bridge and other steel fabrication work. We also undertake fabrication work of FOB to be executed at site.

## **RUBBER PROFILE**



Catering to the automotive industry, We are manufacturer and supplier of many products like **Bus Body Building Profiles, Architectural /Aluminium & UPVC Section Profiles, Railway Windows & Door Profiles, Glass Run Channels (Flocked), Wind Shield Rubber Profiles** and many others. All the products are made using avant-garde material like steel, alloy, aluminum and others. Further, modern and efficacious techniques are used to shape the products as per industry's guidelines. Hence, our rubber products and other ambit is a perfect amalgamation of quality and cost.

**Anil Gupta ( Director +91-9811132251 )**

Regd. Office : Plot No.6, Gali No.6, Rsghuveer Colony, Sec-2, Ballabgarh, Faridabad, Haryana (India)-121004

Factory : Plot No. 895, SEC-69, IMT, Faridabad (Haryana)-121004 INDIA

E-mail : [info@sairubbers.in](mailto:info@sairubbers.in), [sairubberengg@gmail.com](mailto:sairubberengg@gmail.com),

Website : [www.sairubbers.in](http://www.sairubbers.in)

Mob : +91- 9311132251, 9911132251, 9811132253



# **SAI RUBBER ENGG. PVT. LTD.**

**(A UNIT OF SAI GROUP OF COMPANIES)**

**(AN ISO : 9001-2015 CERTIFIED CO.)**

- **All types of Bridge Bearings**
- **Bridge & Building Expansion Joints With Seals**
- **Bridge Rehabilitation Work**
- **Foot Over Bridge & Steel Girder Fabrication**
- **Crash Barriers**
- **All Kinds Of Steel & Rubber Components For Bridge**

## BRIDGE BEARINGS

A Device provided in between the Substructure and the Superstructure to control the interaction of these two is called Bearing. The function of a bearing is to safely transmit the Loads and Forces acting on to or from the Superstructure to the substructure underneath while providing for free translation and rotation of the structure supported by the bearing.

**TYPE OF BEARINGS :** There are three types of bridge bearings used in bridges :

- POT-PTFE BEARING
- ROCKER-ROLLER BEARING
- ELASTOMERIC NEOPRENE BEARINGS ETC.

**1. POT-PTFE BEARINGS :** There are following types POT Bearing used in bridge.

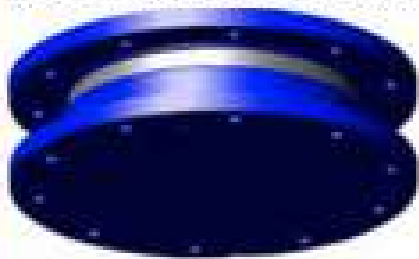

FIXED POT BEARING



FREE POT BEARING

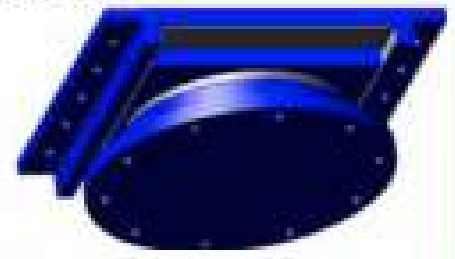

GUIDED POT BEARING

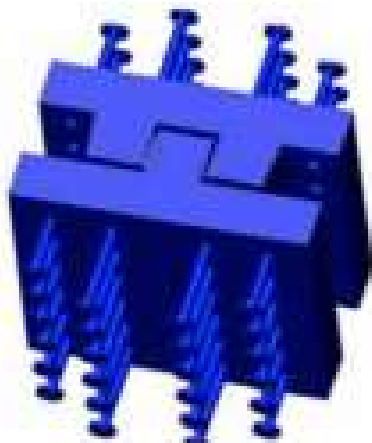

METALLIC GUIDE BEARING



PIN FIXED POT BEARING



FREE FLOAT POT BEARING

**2. ROCKER-ROLLER BEARINGS :** These bearings are commonly used in Railway / steel girder bridges.

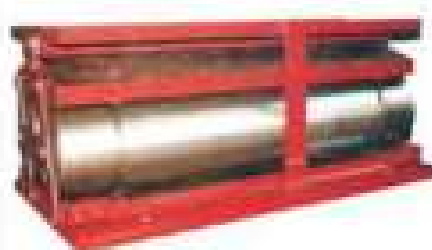

**3. ELASTOMERIC (NEOPRENE) BEARINGS :** These bearings are used in RCC Bridges / Metro Bridges.



## BRIDGE EXPANSION JOINTS :

Expansion Joint is the device used to bridge the Gap provided in between the Structural Elements that could either be the two adjacent deck segments or in between the Abutment and the first deck Slab of the Bridge Structure. There are following types of expansion joints used in bridges.

### 1. STRIP SEAL TYPE EXPANSION JOINTS (Cater for a movement upto 80 mm)

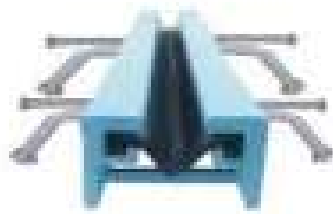

SAI F-TYPE EJ



SAI K-TYPE EJ



SAI M-TYPE EJ

### 2. COMPRESSION SEAL JOINT

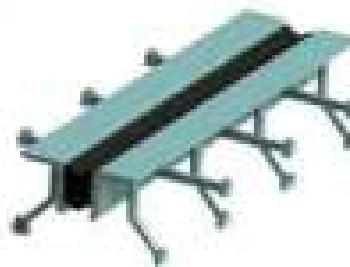

### 3. SLAB SEAL JOINT

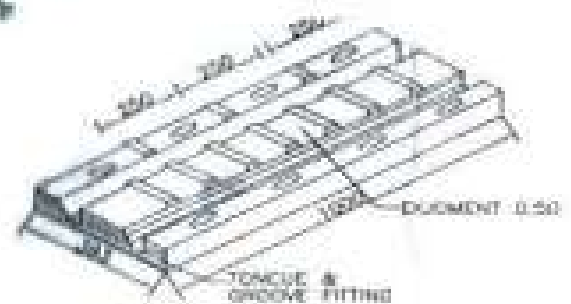
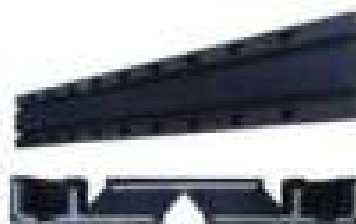

ELASTOMERIC SLAB SEAL EXPANSION JOINTS

### 4. COPPER PLATE JOINT

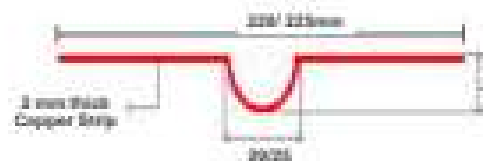
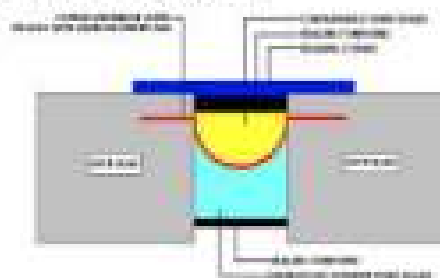

### 5. OMEGA TYPE EXPANSION JOINT



# Foot Over Bridge & Steel Girder Fabrication



## BRIDGE DRAINAGE SPOUT

A drainage spout is a vertical pipe for carrying rainwater down from a platform. It is made from mild steel and galvanized to prevent corrosion or rusting due to water flowing through the pipe. Drainage spouts are manufactured and supplied according to MORTH specifications.

### Features:

- |                                       |                         |
|---------------------------------------|-------------------------|
| a) Withstand harsh weather conditions | b) Sturdy construction  |
| c) Durable                            | d) Suspension designs   |
| e) Involves fabrication               | f) Corrosion resistance |

